

ITEM NO.	PART NUMBER	DESCRIPTION	QTY.
1	AD-6801 10-12	ADAPTER 10MJ x 12MP 90	1
2	AD-6500 10-10	10FJ x 10MJ 90, ADAPTER	1
3	AD-4604 16-20	HOSE INSERT 4404-16-16MP	1
4	PU-15433 PLATE	MOUNTING ADAPTER	1
5	PU-MA6ACU	2 GROOVE CLUTCH	1
6	PU-CP16 65C 05	SIDE PORT PUMP ONLY	1
7	EL-SK-100	PUMP SWITCH KIT	1

REV.	DESCRIPTION	DATE	APPROVED
A	INITIAL RELEASE	3/1/2013	
B	UPDATED BOM TO 16-16MP	12/13/2013	
C	UPDATED PART NUMBERS AND ADDED ITEM NO.7	11/7/2023	KD (BB)

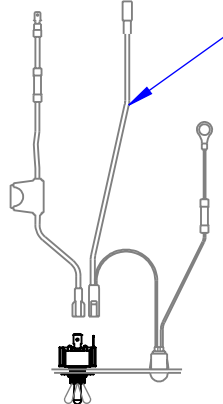

EL-SK-100: QTY 1
"SWITCH KIT, DASH"
SEE DWG 10-0931-14
FOR MORE DETAILS

PU-SP4-11

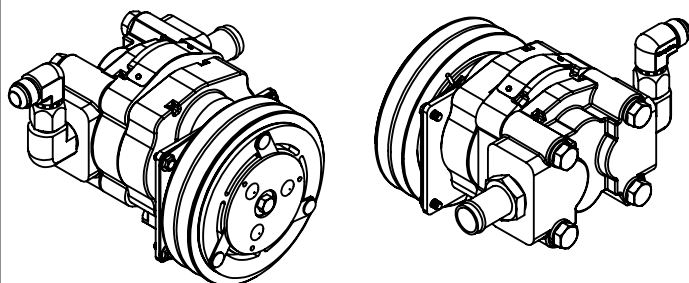
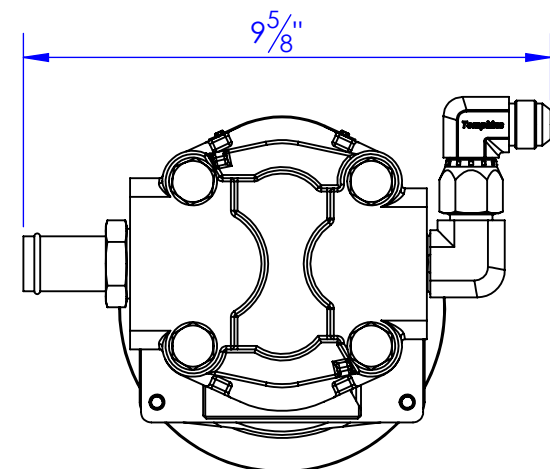
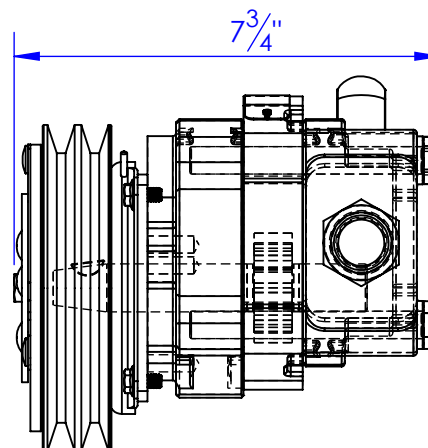
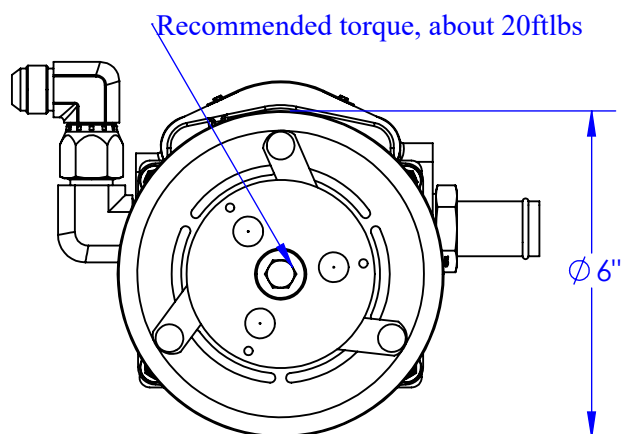
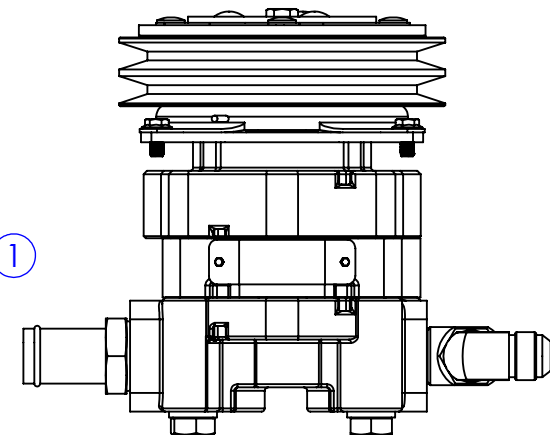
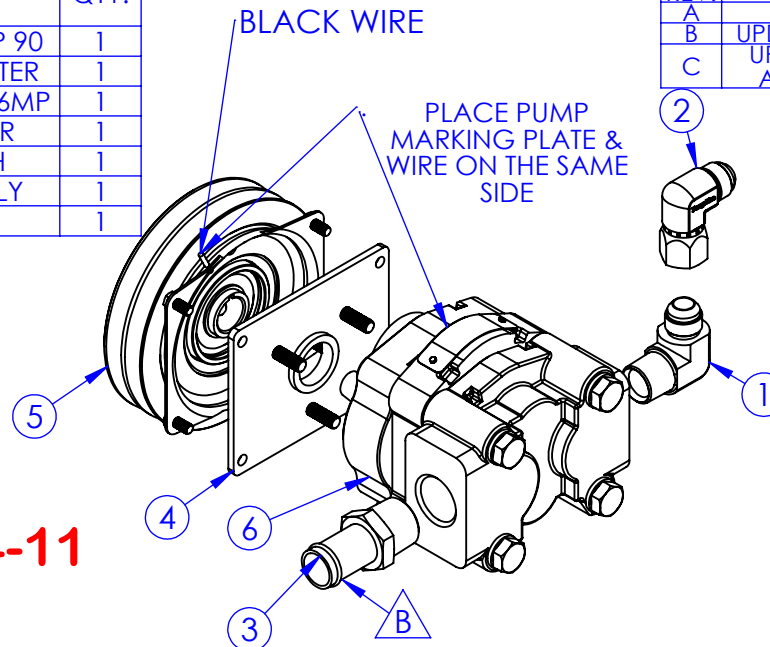

PROPRIETARY AND CONFIDENTIAL
THE INFORMATION CONTAINED IN THIS
DRAWING IS THE SOLE PROPERTY OF TRIPLE
C INC. ANY REPRODUCTION IN PART OR
AS A WHOLE WITHOUT THE WRITTEN
PERMISSION OF TRIPLE C INC. IS PROHIBITED.

DIMENSIONS ARE IN INCHES
TOLERANCES:
FRACTIONAL $\pm 1/16$
ANGULAR: MACH ± 1 BEND \pm
TWO PLACE DECIMAL ± 010
THREE PLACE DECIMAL ± 005

MATERIAL ---
DO NOT SCALE DRAWING

NAME	DATE
DRAWN HEATH	11/7/2023
PART # PU-SP4-11	
ASM #	

COMMENTS:
**2 GROOVE SIDE
PORT PARKER
PUMP**

P.O. BOX 248,
SABETHA, KS 66534



SIZE A	DWG. NO. 10-0931-07 C	REV. C
SCALE: 1:3.5	WEIGHT: ---	SHEET 1 OF 1